

**S-BOX**<sup>TM</sup>  
SURFACE

**2-PORT MINI**

**3-PORT** with or without USB



## CUTTING INSTRUCTIONS AND INSTALLATION GUIDE



**WE RECOMMEND THAT ALL 'CUT-OUT' PROCESSES SHOULD BE DONE BY YOUR SPECIALIST WORKTOP PROVIDER**

The S-Box™ SURFACE Model is specifically designed for a simple installation into any Work Surface.

The unit drops straight into a rectangular hole, and is immediately ready to deliver its valuable hidden payload by way of its press-down, 'pop-up' action.

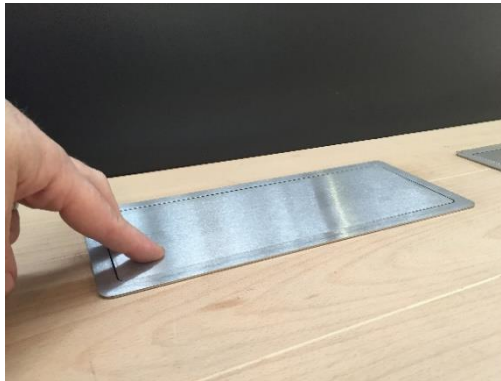
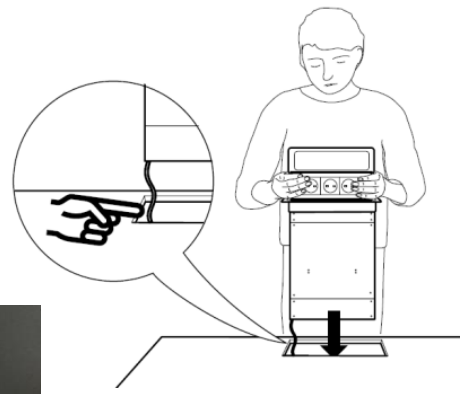

PLEASE REMEMBER TO REMOVE THE INTERNAL TRANSIT CUSHION.

[THE FRONT DOOR OF THE UNIT TO DO THIS, IS HELD BY T20 STARBIT SCREWS]

All that is required is for the correct size hole to be cut out, either by factory machine in materials such as Granite, Quartz, Marble, Composite etc, or by drill and saw on site in the case of easier-to-work materials such as Timber.

The dimensions of the thru-cut holes for S-Box™ surface-fit models are shown below.

**POWER SOCKETS**

	A	x	B
S-BOX™ MINI (2 PORT)	98mm		211mm
S-BOX™ 3-PORT with or without USB	115mm		295mm

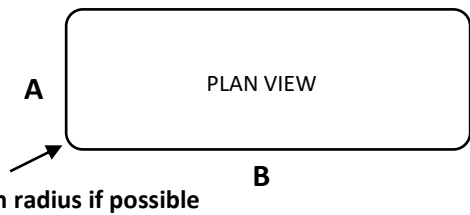

The thru-view diagram below shows the position of the unit inserted into any thickness material. On the left is a Standard Mount, with the collar sitting flat on the surface of the Counter. On the right is stylish second option, in which the collar sits flush with the counter by being inserted into a shallow rebate cut by the fitter. This should be 8mm wider than the hole-dimensions above.

**IN EITHER INSTALLATION PLEASE DO NOT USE MASTICS OR ADHESIVES. THE UNIT'S OWN WEIGHT WILL HOLD IT IN POSITION, AND ALLOWS FOR EASY REMOVAL OF THE UNIT LATER IF NECESSARY.**

