



120v



Intertek

S-BOXTM
CHAMELEON

2-Port (1 x Socket + A+C USB 25W)



3-Port with 2 sockets + A+C USB 25W

POP-UP SOCKETS



2-Port (2 x Sockets)

featuring

"NEXT GENERATION" USB TECHNOLOGY



S-BOX™ 2012-2022



US Patent 8899701



Intertek

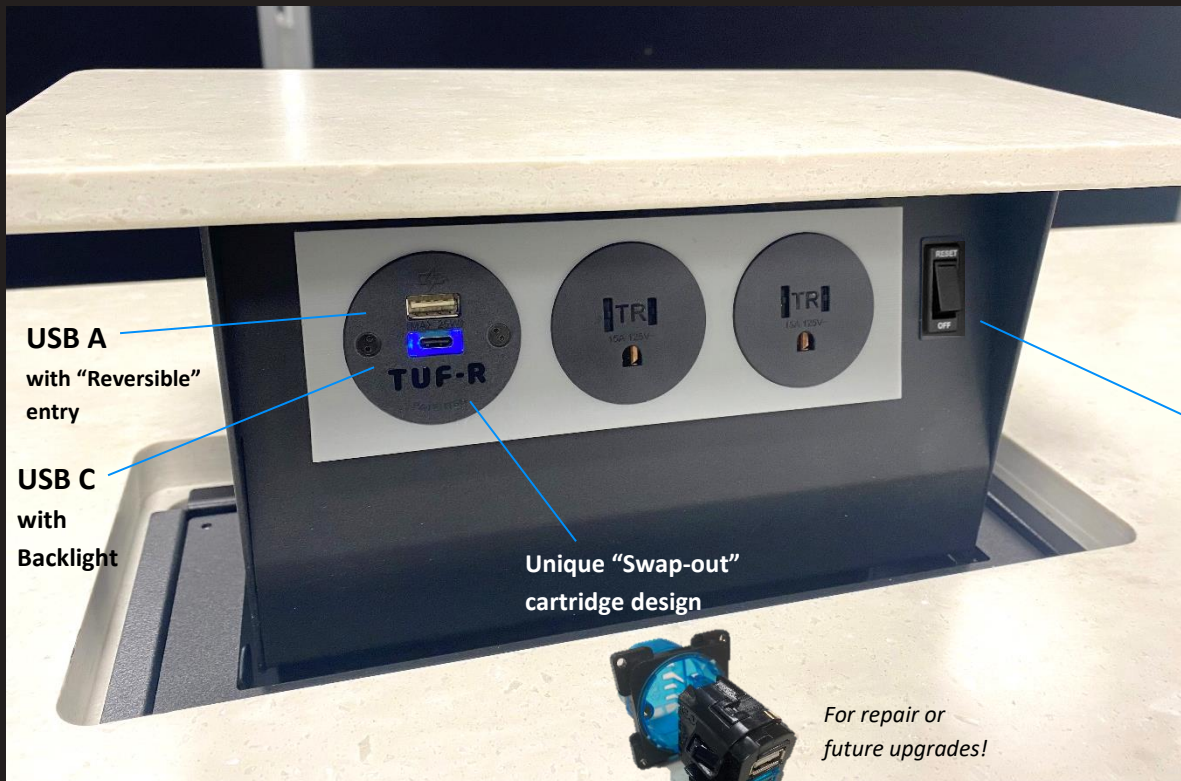

USB A
with "Reversible"
entry

USB C
with
Backlight

Unique "Swap-out"
cartridge design

For repair or
future upgrades!

MCB (Mini Circuit
Breaker) current
overload safety
switch set at 15A
= 'built-in' GFCI

US Nema
15A sockets

25 Watts of 'clever' power

The new TUF-R® A+C USB charger offers different supply voltages depending on the device being charged.

When a device is plugged in to either Type A or Type C socket a digital 'handshake' takes place allowing the TUF to charge the device at the optimum level.

USB Type C 5 Volts x 3 Amps = 15 Watts
 9 Volts x 2.22 Amps = 20 Watts
 15 volts x 1.65 Amps = 25 Watts
 20 Volts x 1.2 Amps = 24 Watts

USB Type A 5 Volts x 3 Amps = 15 Watts
 9 Volts x 3 Amps = 18 Watts
 12 volts x 1.5 Amps = 18 Watts

+ 'COMMERCIAL GRADE' MODEL
WITH ULTRA-HIGH POWER of 72 WATTS!
For Laptop/Tablet/MacBook® & Office



Provides: 60W to Type C
12W to Type A

"Comms" options also available >



HDMI



RJ45





2-PORT MINI

Comprising 2 x US Nema 15a (Type B) plug sockets

Code: SB-CHAM-MINI-US

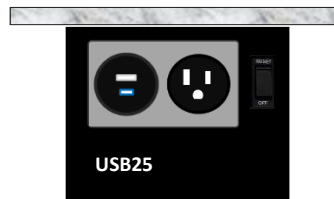

2-PORT MINI USB

Comprising 1 x US Nema 15a plus A+C USB (25W)

Code: SB-CHAM-MINI-US-USB25



25W USB-C for fast Mobile Phone charging



3-PORT (3 x Sockets)

Comprising 3 x US Nema 15a (Type B) plug sockets

Code: SB-CHAM-01-US



3-PORT (2 x Sockets + USB A+C 25W)

Comprising 2 x US Nema 15a (Type B) plug sockets plus A+C USB (25W)

Code: SB-CHAM-02-US-USB25



25W USB-C for fast Mobile Phone charging



3-PORT (2 x Sockets + USB A+C 72W)

Comprising 2 x US Nema 15a (Type B) plug sockets plus A+C USB (72W)

Code: SB-CHAM-02-US-USB72



60W USB-C for Ultra-high-power charging (tablets, laptops etc.)

COMMS OPTIONS

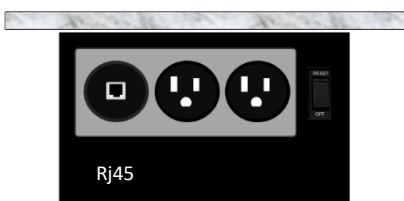

3-PORT (2 x Sockets + RJ45)

Comprising 2 x US Nema 15a (Type B) plug sockets plus RJ45 connection and cable tail for onward connection

Code: SB-CHAM-03-US



RJ45 for Ethernet connection



3-PORT (2 x Sockets + HDMI)

Comprising 2 x US Nema 15a (Type B) plug sockets plus RJ45 connection and cable tail for onward connection

Code: SB-CHAM-04-US



HDMI for connection to Laptop & Office Presentations

RJ45 AND HDMI UNITS ALSO INCLUDE EXTENSION TAIL AND 'FEMALE' CONNECTOR.





INTERNATIONAL POP-UP SOCKETS



USED BY DESIGNERS IN 70 COUNTRIES



S-BOX™

A British Design Innovation 

S-BOX® USA:

Innovative Product Sales International LLC, 7345 West Friendly Ave. Suite C, Greensboro, NC 27410

Tel: +1 336-223-8047 Email: ken@innovativeproductsinc.com Website: www.sbox-usa.com

S-Box™ is a Registered Trademark

The S-Box™ pop-up action and top-change feature are protected by International Patents in UK, EU, USA, CANADA, AU & ASIA.

COUNTERTOPS & ISLANDS

“Within Article 210.52(A) (1) of the 2020 NEC, it has been revised to require at least one receptacle within the first nine square feet of an island countertop and an additional receptacle for every 18 square feet more, or fraction thereof.”

AMPERAGE of OUTLET RECEPTACLES

“General-purpose outlets (e.g. wall receptacles) should have a rating that is appropriate for the amperage of the circuit they serve. Generally, these household circuits will provide 15-amps or 20-amps of service, and the outlet receptacle rating should not exceed this amperage”

There is no danger to installing 15-amp outlet receptacles on a 20-amp circuit (in fact, this is the standard practice, especially for supplemental low power accessories and countertop convenience)

“A 20-amp receptacle is generally reserved for locations where a heavy-duty appliance is typically used, such as an outlet that might power a space heater but it is only installed on a 20-amp or larger circuit.”

What is a GFCI Receptacle?

“You can tell if a receptacle is a GFCI one or not by the way it looks.

The GFCI is integrated into an electrical outlet and it typically has a red (or possibly white) reset button on the outlet's faceplate. The outlet monitors how much energy is going into it when in use.



“If the receptacle senses any sort of an electrical overload or imbalance, it is designed to trip the circuit in a fraction of a second.

GFCI receptacles are generally used instead of a standard outlet receptacle to offer protection to single outlet location”

S-Box™ Pop-up Countertop Sockets feature their own built-in Mini Circuit Breaker (MCB) with current overload protection pre-set to 15A.
MCB = GFCI ☺

**Cord and plug-connected receptacle assemblies**

are Certified (Listed) for installation into stationary furniture countertops under the product category Furniture Power Distribution Units (FPDU). Cord and plug connected assemblies are investigated for compliance with the requirements in **ANSI/UL 962A**

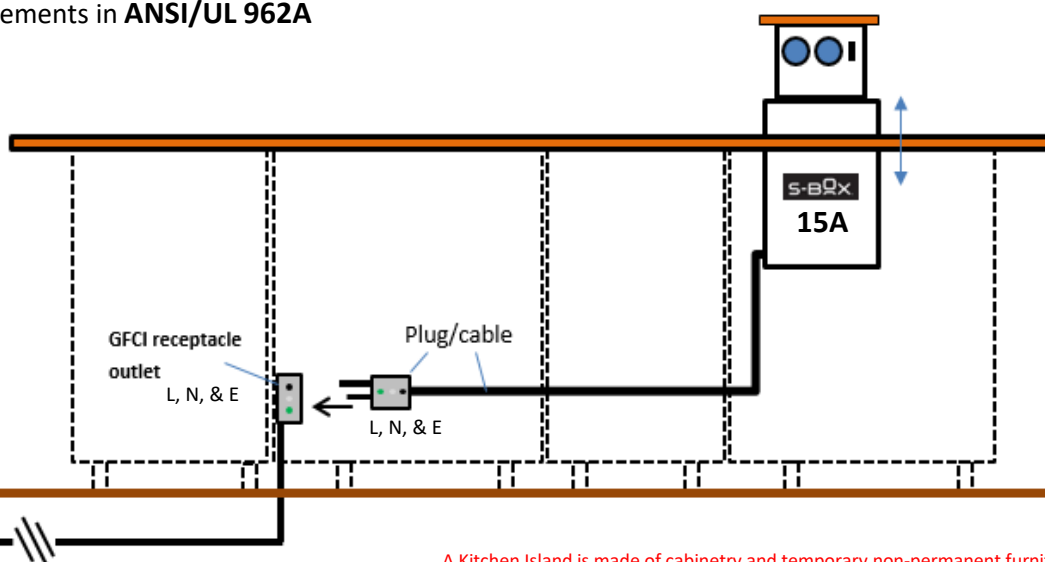

S-Box™ products are fully compliant and correctly listed for use in kitchen and bathroom countertops.

It is their extractability and unique design that means they must be corded and therefore classified as an FPDU, rather than a fixed (hard-wire-only) device under UL 498

20A or 15A mains Circuit

A Kitchen Island is made of cabinetry and temporary non-permanent furniture. All kitchens are constructed from modular or hand-crafted materials (such as Timber, Mdf or similar) and whilst they are of course “stationary”, they are also inherently remove-able, up-grade-able, and change-able at any time, either by the existing home-owner or any new home-owner who chooses to do so after purchasing an existing dwelling.

Report Number	105286428BOX-001	Issued: 29-Jun-2023	
Standard(s)	Furniture Power Distribution Units [UL 962A:2018 Ed.5+R:17Mar2022] Cord Reels and Multi-outlet Assemblies [CSA C22.2#308:2018 Ed.2]		
Applicant	Cardinal Innovations Ltd	Manufacturer 1	Cardinal Innovations Ltd
Address	Battye Street, Bradford, West Yorkshire, BD4 8AG	Address	Battye Street, Bradford, West Yorkshire, BD4 8AG
Country	England	Country	England

Description	The product covered by this report is a range of pop-up Sockets for Countertop location. For use in Stationary Furniture (such as Kitchen Islands or Kitchen cabinets). Operated/self-powered/adjustable lift mechanism by "gravity" (US Patent No. 8899701 Canada Patent No. 2700325). For Indoor use only - in kitchen countertops (as well as office and commercial locations). A corded device (to enable its removal/adjustment within its countertop location). Designed for connection to a GFCI outlet (of 20A or less) as per rules of UL 962A.
-------------	--

This authorizes the application of the Certification Mark(s) shown below to the models described in the Product(s) Covered section when made in accordance with the conditions set forth in the Certification Agreement and Listing Report. This authorization also applies to multiple listee model(s) identified on the correlation page of the Listing Report.

This document is the property of Intertek Testing Services and is not transferable. The certification mark(s) may be applied only at the location of the Party Authorized To Apply Mark.

Applicant:	Cardinal Innovations Ltd	Manufacturer:	Cardinal Innovations Ltd
Address:	Battye Street, Bradford, West Yorkshire, BD4 8AG	Address:	Battye Street, Bradford, West Yorkshire, BD4 8AG
Country:	England	Country:	England
Party Authorized To Apply Mark:	Same as Manufacturer		
Report Issuing Office:	Intertek Testing Services NA, Inc., Boxborough, MA		

Control Number: 5026088

Authorized by: _____

for L. Matthew Snyder, Certification Manager



This document supersedes all previous Authorizations to Mark for the noted Report Number.

This Authorization to Mark is for the exclusive use of Intertek's Client and is provided pursuant to the Certification agreement between Intertek and its Client. Intertek's responsibility and liability are limited to the terms and conditions of the agreement. Intertek assumes no liability to any party, other than to the Client in accordance with the agreement, for any loss, expense or damage occasioned by the use of this Authorization to Mark. Only the Client is authorized to permit copying or distribution of this Authorization to Mark and then only in its entirety. Use of Intertek's Certification mark is restricted to the conditions laid out in the agreement and in this Authorization to Mark. Any further use of the Intertek name for the sale or advertisement of the tested material, product or service must first be approved in writing by Intertek. Initial Factory Assessments and Follow up Services are for the purpose of assuring appropriate usage of the Certification mark in accordance with the agreement, they are not for the purposes of production quality control and do not relieve the Client of their obligations in this respect.

Intertek Testing Services NA Inc.
545 East Algonquin Road, Arlington Heights, IL 60005
Telephone 800-345-3851 or 847-439-5667 Fax 312-283-1672

Standard(s):	Furniture Power Distribution Units [UL 962A:2018 Ed.5+R:17Mar2022]
Product:	Furniture Power Distribution Units
Models:	SB followed by -PS; followed by -SS or -CHAM; may be followed by -MINI or -01 or -02 or -03 or -04 or -05 or -06 or -07 or -08 or -09; may be followed by -TR20 or -US; may be followed by -USB25 or -USB72

THE WORKTOP - RULES 1 & 2

- 1** S-BOX® CHAMELEON MODELS are supplied **without a top**, and are designed to drop into a pre-cut hole in the Counter **on a rebate at exactly 20mm below the surface i.e. a 'shelf' of material.**
- 2** They are duly ready to receive their own matching piece of worktop (up to 12mm maximum thickness) to be used as the custom top.

CUTTING OF STONE MATERIALS SUCH AS GRANITE & QUARTZ IS A **FACTORY PROCESS** SO PLEASE INVOLVE THE FABRICATOR OF SUCH MATERIALS IN THE DESIGN & SPECIFICATION PROCESS

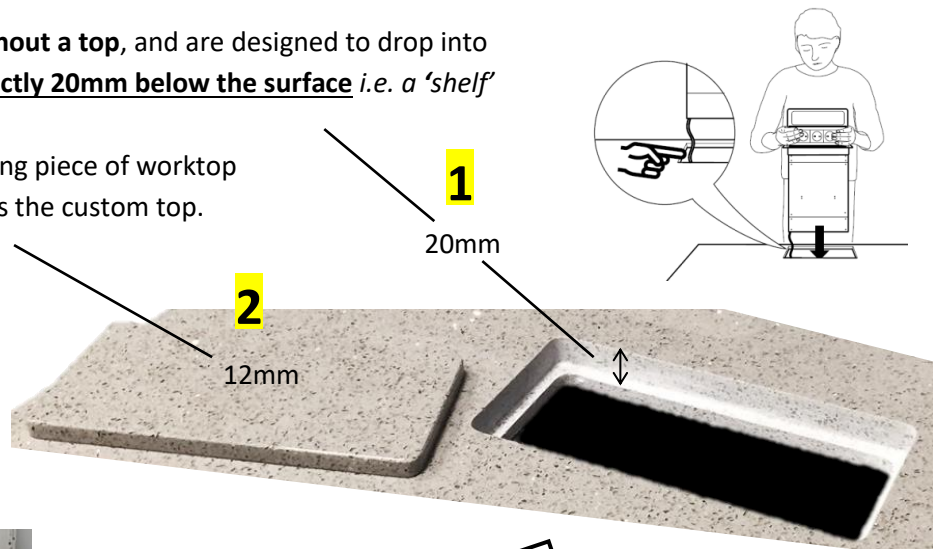

Router-tool follows instruction



Router-tool above material

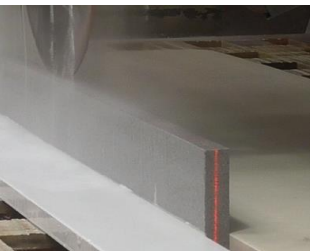

Slicing off-cut for 12mm Top



Router-tool cutting the hole

This rebate is either a **"True Rebate"** - e.g. one that is pre-cut by a router **within** thick material (30mm and over)

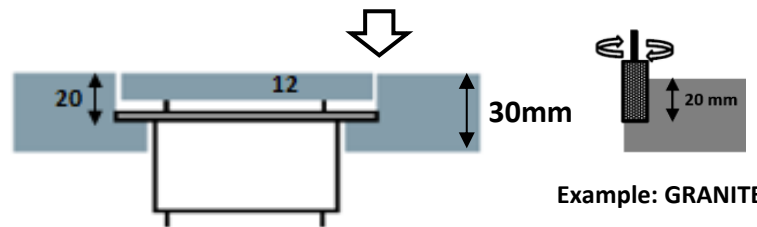

Example: GRANITE

OR it is a **"False rebate"**. This is one that is *created* directly below thinner material (20mm or less) by using a **secondary material bonded underneath** to 'create' the shelf.

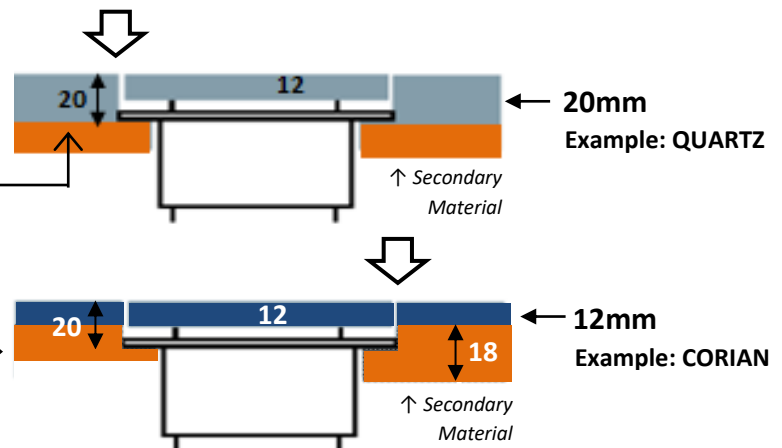

Example: QUARTZ

Example: CORIAN

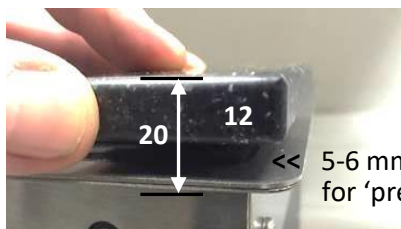
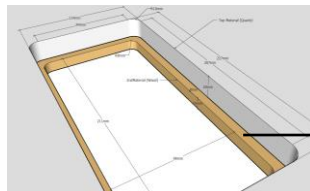
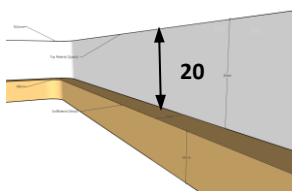

<< 5-6 mm clearance for 'press down' action

CLICK THIS LINK

FOR FULL INSTRUCTIONS + CUTTING DIMENSIONS > > <https://www.the-sbox.com/tech-data/>

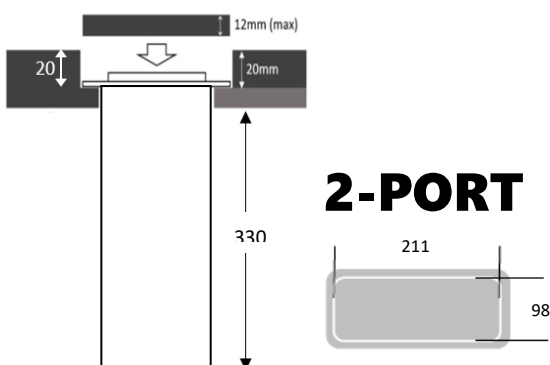

2-PORT

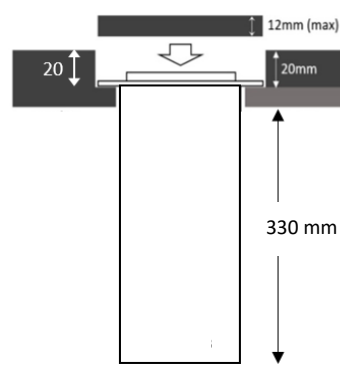

3-PORT

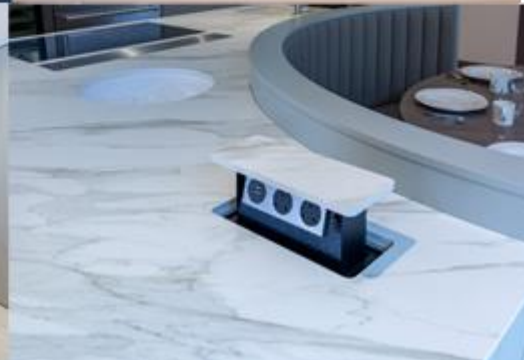



JUST IN CASE IT IS REQUIRED, THERE *IS* A 20A S-BOX™ MODEL WHICH ALSO DELIVERS INVISIBLE POWER TO THE COUNTERTOP. FULLY COMPLIANT AND CERTIFIED TO BOTH UL962A & CSA 22.2 STANDARDS THIS MODEL FEATURES A 20A 'DUPLEX SOCKET' DESIGN WITH SIMPLE ON/OFF SWITCH.

Note: this unit can only be connected to a 20A Circuit



The unit is installed into the Counter-top (into a 20mm rebate) as per the "TWO RULES" above and is ready to receive its 12mm max Custom Top.

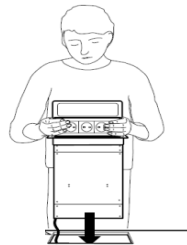

This unit has also passed the 64oz Splash test for use in Wet Areas under NEC Regulation **NEC 406.5 (E)**

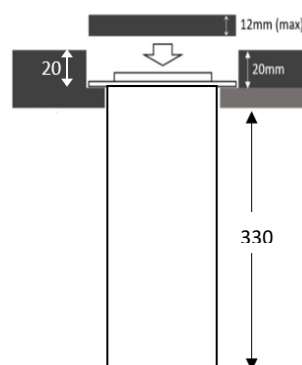

Dimensions are identical to the S-BOX™ 15A 2-PORT models

**2-SOCKET DUPLEX
20A**

